

ANSI125/150 Bolt Circle

Fig. SLC - 605

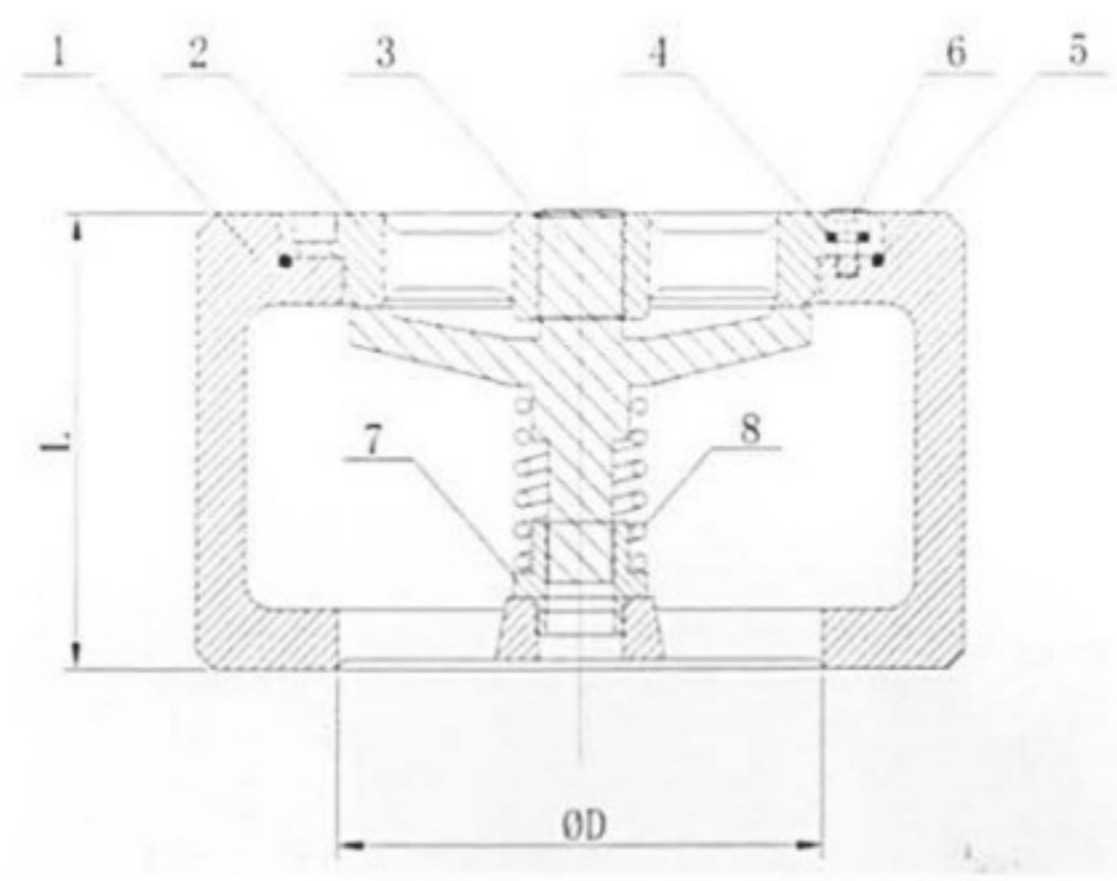
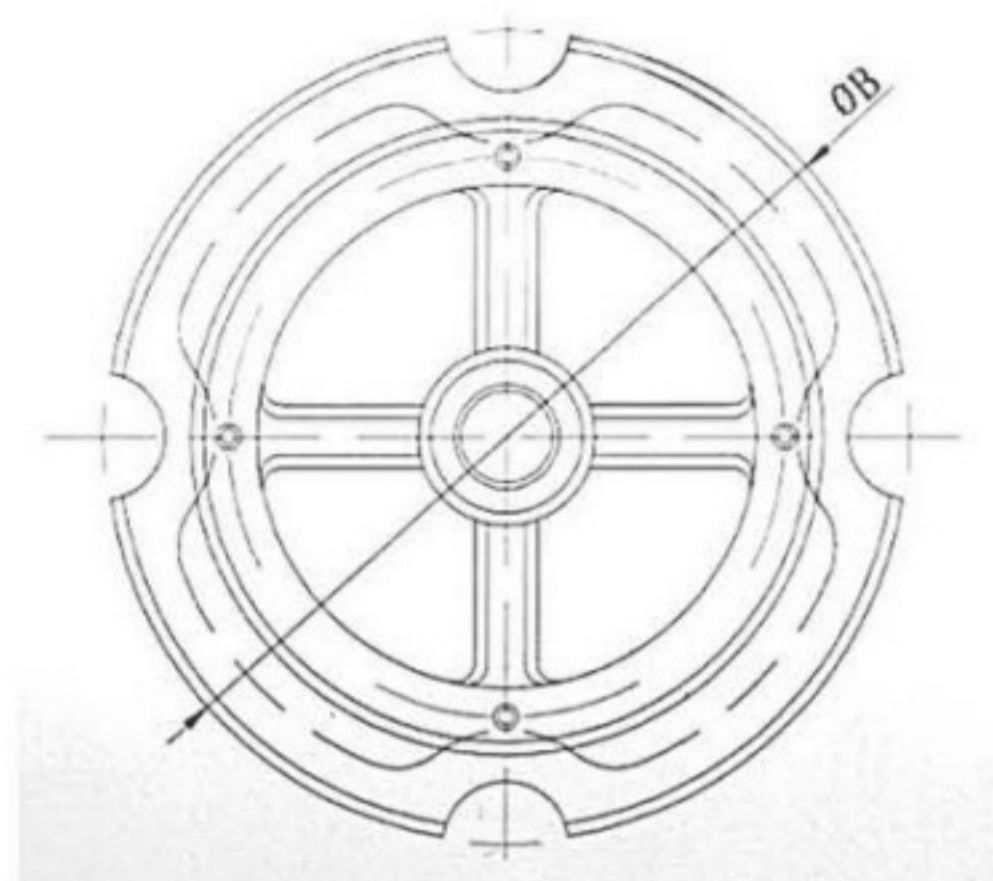

SPECIFICATION

- Design and Manufacture : KISTLER Standard.
- Face to Face dimensions : ASME B16.1
- Pipe Flanges and Flanged ends : ASME B16.1

FEATURE and APPLICATION

1. Eliminate water hammer with a check valve that operate smoothly and silently itself. This series features hand-lapped stainless steel to EPDM seating with special stainless steel spring control to ensure positive, noiseless opening and closing.

2. The mating surfaces of the seat and disc are hand lapped. The disc is fully guided at the top and bottom to prevent binding and cocking. Parts can be replaced in the field - no special tools required. Disc for all sizes open with less than one pound per square inch pressure.

INSTALLATION

Equally effective installed vertically, horizontally and angle consult factory for downward vertical flow. We strongly suggest the installation of stainless in the piping, located before the pump. This inexpensive measure will insure protection for both the pump and valve.

CAUTION

Not suggested for installations in sewage ejector piping nor are they recommended for use with reciprocal compressors or pumps.

PERFORMANCE

NOMINAL DIAMETER (mm)		50 (2") - 300 (12")
Max. Working Pressure		232 psi. (16 bar)
Hydrostatic Test	Body	333 psi. (23 bar)
	Seat	232 psi. (16 bar)

MATERIALS

NO.	NAME OF PARTS	SPECIFICATION
1	Body	Cast Iron A126 Class B
2	Guide	Stainless Steel 316
3	Disc	Stainless Steel 316
4, 5	O-Ring, Seat ring	EPDM
6, 7	Bolt, Sleeve	Stainless Steel 316
8	Spring	Stainless Steel 316

DIMENSIONS

mm.

SIZE		L	ØB	ØD
mm.	inch			
50	2"	67	108	59
65	2.1/2"	73	127	80
80	3"	79	150	84
100	4"	102	174	112
125	5"	117	213	130
150	6"	140	248	164
200	8"	165	340	216
250	10"	210	406	245
300	12"	286	482	300